



90°Tilt



WH BK SV

Kenzo

- Aluminum material in powder coating, with polycarbonate driver box.
- Lumileds COB, Ra>90, CCT 3000K/4000K/5000K in option.
- Philips driver, PF>0.95, Triac / 0-10V / Dali in option, (see details in main catalogue).
- Designed with traditional light sources, likes Gx5.3 for MR16, GU10 for QPAR16, G53 for QR111, and G8.5/G12 for CDM / CDM-T, accessories available.
- 3 phase track and 1 phase track adaptor are available.

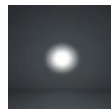

14°

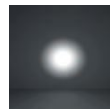

22°

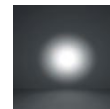

34°



56°

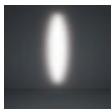

Oval

DALI TRIAC LED IP20 0-10V RA>80 RA>90

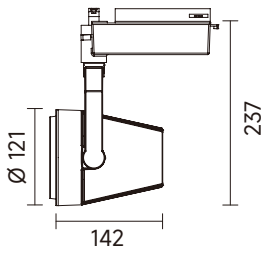

CODE	Watts	CCT	Beam	Lumen
18195-252S	25W	WL 2700K	14°	2268 LM
18195-252M	25W	WL 2700K	22°	2037 LM
18195-252L	25W	WL 2700K	34°	2149 LM
18195-252W	25W	WL 2700K	56°	1962 LM
18195-253S	25W	WL 3000K	14°	2338 LM
18195-253M	25W	WL 3000K	22°	2100 LM
18195-253L	25W	WL 3000K	34°	2215 LM
18195-253W	25W	WL 3000K	56°	2023 LM
18195-254S	25W	NL 4000K	14°	2572 LM
18195-254M	25W	NL 4000K	22°	2310 LM
18195-254L	25W	NL 4000K	34°	2436 LM
18195-254W	25W	NL 4000K	56°	2225 LM
18195-25CS	25W	CL 5700K	14°	2829 LM
18195-25CM	25W	CL 5700K	22°	2541 LM
18195-25CL	25W	CL 5700K	34°	2680 LM
18195-25CW	25W	CL 5700K	56°	2448 LM

TRIAC G53 IP20



CODE

Watts

18191	100W
18191L	100W

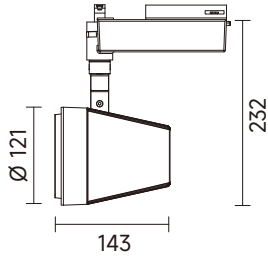

TRIAC GX5.3 IP20



CODE

Watts

18091	50W max
18091L	50W max

